

# Focus

SPECIAL EDITION

## Design Excellence Awards 2000

**Distinguished Building, Interior  
Architecture and Unbuilt Design**

AIA Chicago

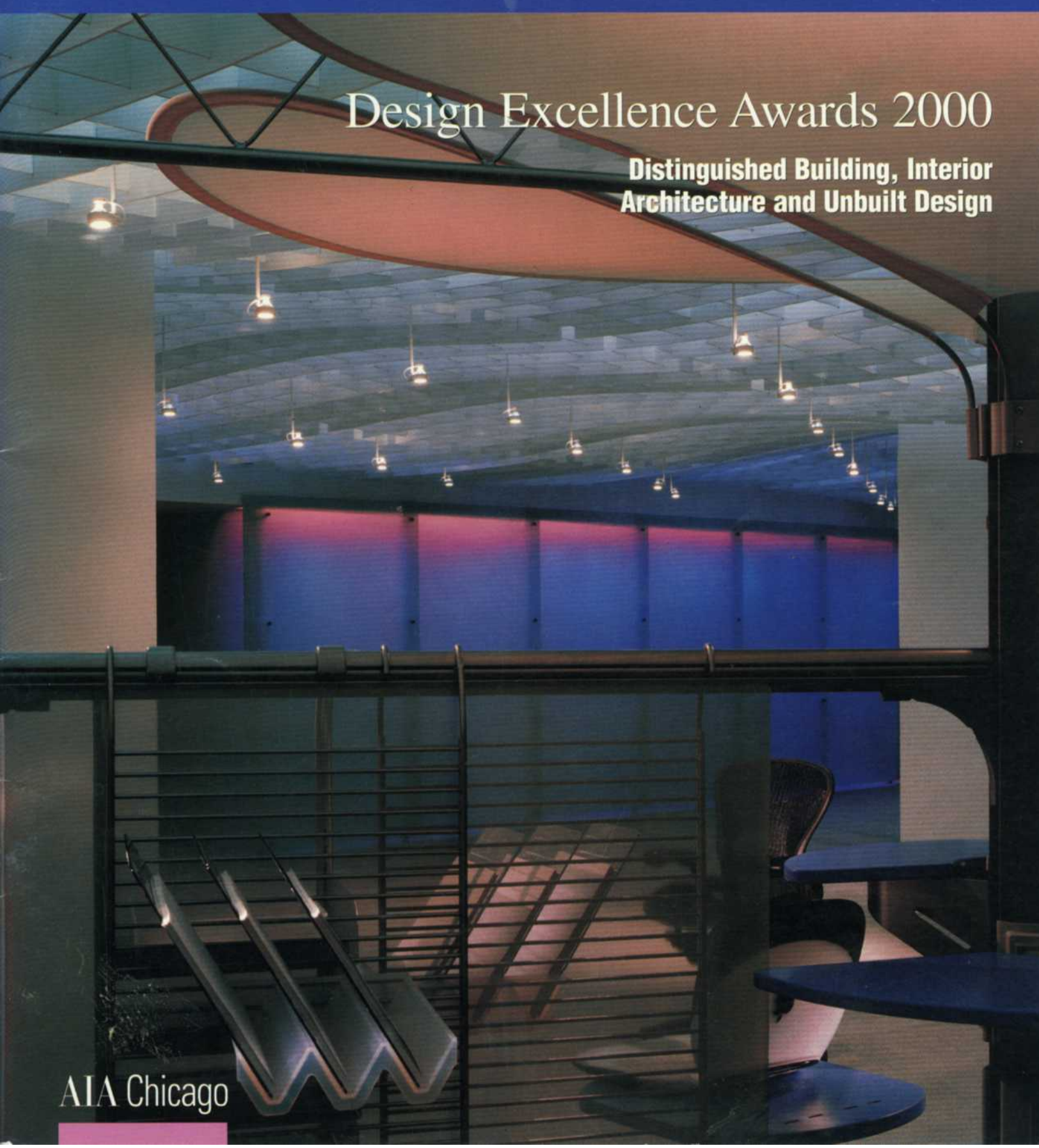

# Interior Architecture Awards

**T**he Interior Architecture Award was established two decades ago to promote interior architecture as a unique profession by recognizing outstanding projects. For award purposes, interior architecture is defined as the space within a building envelope, including design of lighting, finishes and furnishings. The jury considers a wide range of design projects completed between January 1, 1997 and May 1, 2000.



## **Bethany Place** Belleville, IL

### **Honor Award**

Architect – Rubio/Durham Architects/ISI  
Client – Bethany Place  
General Contractor – Plocher Construction  
Consultants – McGinnis and Associates (structural);  
Spaid Associates (landscape)

Quonset huts, with their harsh materials and military connotations, seem unlikely candidates for conversion to a supportive, welcoming environment for the chronically ill. But a transformation that the jury dubbed “phenomenal” fulfilled that mission, and on a penurious budget of less than \$65 per square foot. Bethany Place is a national leader in innovative care for people with HIV, providing one-stop shopping for all their social service needs. The design goal for this facility was, in the words of Director Tom Adams, “to create a place where people will feel safe and healed, respected and relaxed. We want to send a message that if you’re HIV positive, you can still have nice surroundings.” The unique shape of the Quonset hut interiors, the feeling of expansiveness, the variety of lighting levels, and the attention to design details, all contribute to this feeling of well-being. The successful design also has helped improve a dilapidated neighborhood and raise community awareness of Bethany’s programs, by providing desirable meeting spaces for local civic groups.

Steve Hall © Hedrich Blessing



© Doug Snower Photography

**Astor Street Residence**  
Chicago, IL

**Honor Award**

Architect – Wheeler Kearns Architects Inc.  
Interior Designer – Leslie Jones Interiors  
General Contractor – Harold O. Schultz Co.  
Consultants – Midwestern Engineering,  
George Myrtle (mechanical)

When it comes to designing apartments, architects can either disguise or celebrate the dwelling's essential nature, making it feel like a house that just happens to be 20 stories up, or emphasizing its high-rise character. This project is an exemplar of the latter approach, with an ever-present sense of core and an open periphery defined by the rhythm of columns and vista. "They really took advantage of the 360-degree floor plate and gave it a sense of being lifted up and attached to the core," the jury noted approvingly. Originally three apartments, the 6,000-square-foot residence has an open plan on three sides and a glazed interior corridor that borrows light from the bedrooms on the fourth side. Large, trackless pocket doors provide privacy for the master suite. The kitchen space is defined by an overhead panel of perforated stainless steel that absorbs sound and conceals lighting fixtures. Cabinets set in the kitchen window bays are glazed on both sides; opaque panels at the back screen the lower, less desirable view, while the lake is visible above the cabinet tops.

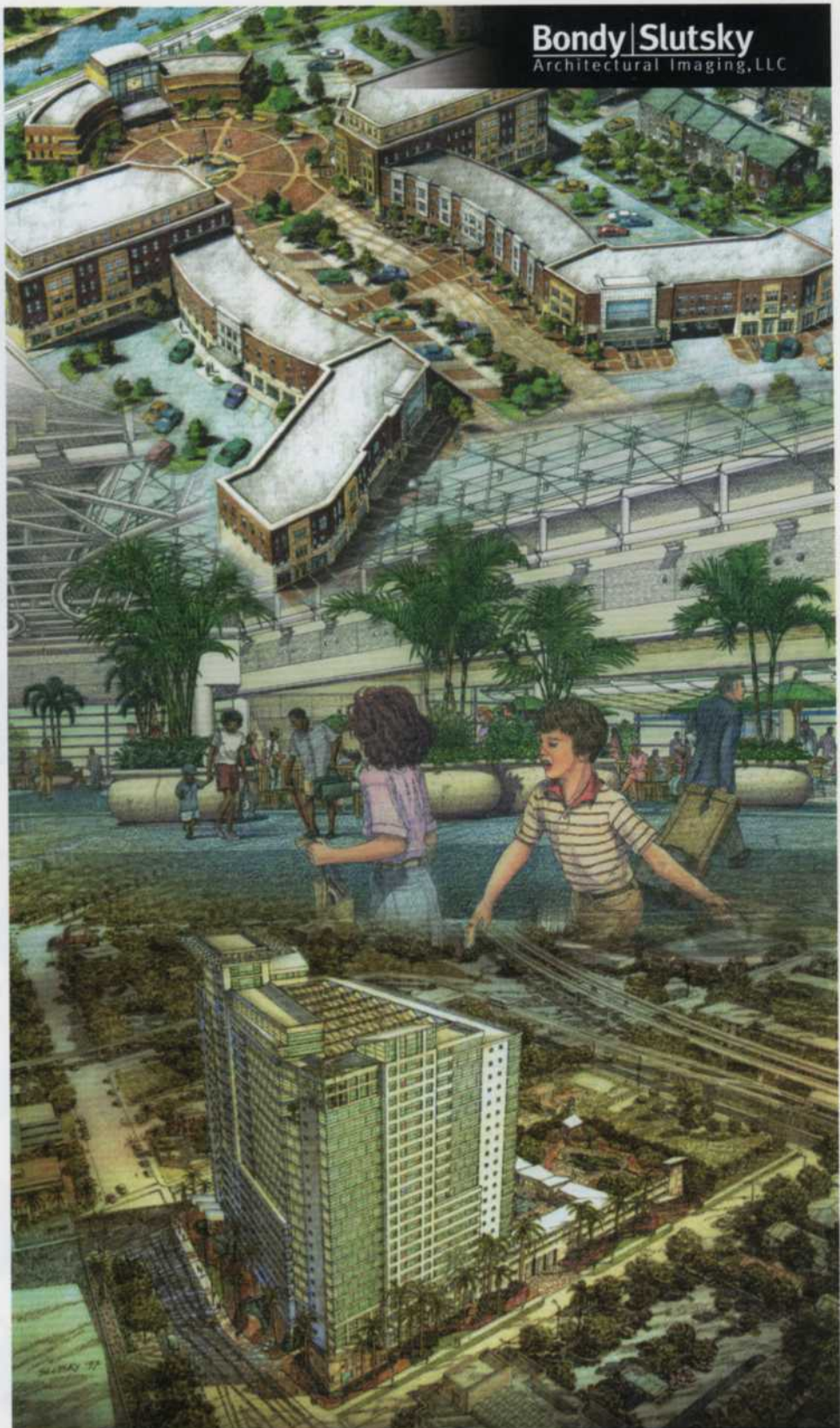

**Contact us**  
Rael D. Slutsky, AIA  
Bruce Bondy  
1514 Chapel Court  
Northbrook IL, 60062  
**847-562-9493**

Digital modeling and rendering  
Interactive virtual reality  
Computer animation  
**Pen and ink renderings**  
Charrette sketches

top: Willow Springs Village Center, Architect: Yas/Fischel Partnership middle: New Orlando International Airport Terminal, Architect: HOK bottom: VESTEC Tower, Miami, Architect: ACI, Inc.